



# PIPING EXPANSION JOINT SURVEY FORM

E-MAIL COMPLETED FORM TO [sales@holzrubber.com](mailto:sales@holzrubber.com)

CUSTOMER: _____	PLANT: _____	UNIT #: _____
DATE: _____	MEASUREMENTS TAKEN BY: _____	
TAG #: _____	LOCATION: _____	FLOW MEDIUM: _____

### OPERATING CONDITIONS

TEMP: _____ °F	PRESSURE: + _____ PSIG	- _____ PSIG
(Z) AXIAL COMPRESSION: _____ in.	(Z) AXIAL EXTENSION: _____ in.	
(X) LATERAL: _____ in.	(Y) LATERAL: _____ in.	

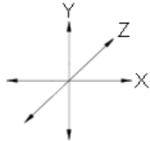

CONDITION OF EXISTING JOINT: \_\_\_\_\_

\_\_\_\_\_

\_\_\_\_\_

\_\_\_\_\_

\_\_\_\_\_

### EXISTING EXPANSION JOINT

MANUFACTURER: _____	MODEL: _____	
STYLE: _____	MATERIAL: _____	
ARCH: SINGLE _____	DOUBLE _____	OTHER _____
FILLED _____	FILLED _____	FILLED _____
SIZE: _____	(in.) DIA. x F/F	
CONCENTRIC SIZE: _____	(in.) DIA. x DIA. x F/F	
ECCENTRIC SIZE: _____	(in.) DIA. x DIA. x F/F	
OFFSET & DIRECTION: _____	(in.) X or Y	
END CONNECTIONS: _____	FLANGED	DRILLING _____ 150# _____ 300# _____ OTHER _____
_____	FLOATING FLANGED	
_____	SLEEVED	

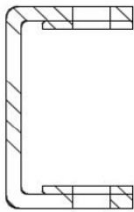

NO ARCH



SINGLE ARCH



DOUBLE ARCH

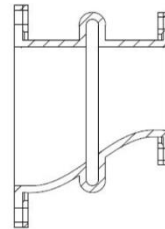

ECCENTRIC

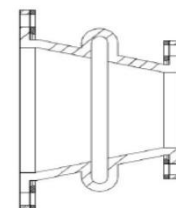

CONCENTRIC

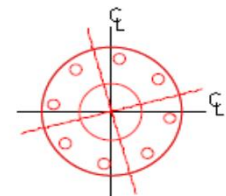
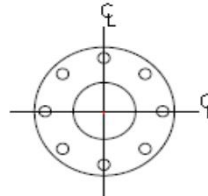
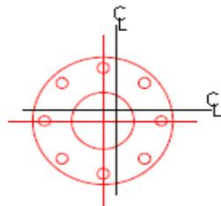
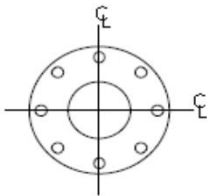

ONE HOLE & TWO HOLE OFFSET

ONE HOLE & TWO HOLE ROTATED